

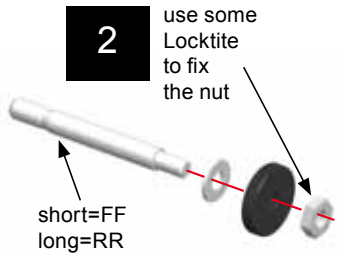

1

use some oil during assembly



2

use some Locktite to fix the nut

short=FF
long=RR

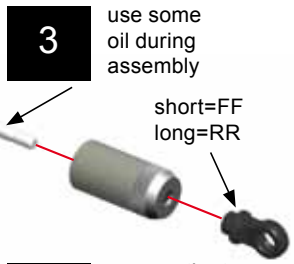

3

use some oil during assembly

short=FF
long=RR

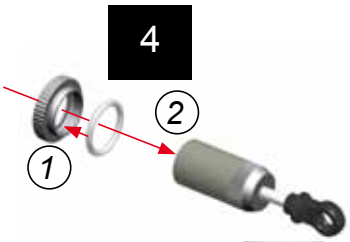

4

assemble the top of the shock this will press the membrane into the shocktop.



6

remove the top of the shock

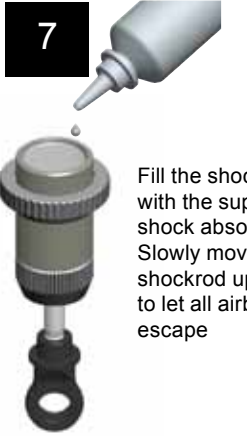

7

Fill the shock body with the supplied shock absorber oil. Slowly move the shockrod up and down to let all airbubbles escape

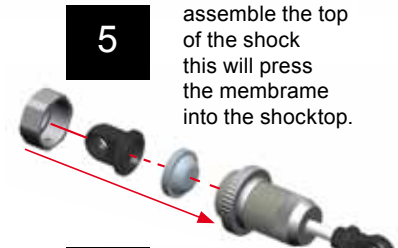

5

close the top of the shock

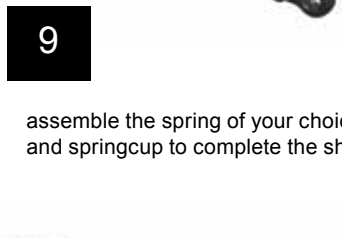

9

assemble the spring of your choice and springcup to complete the shock

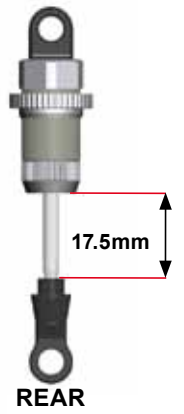
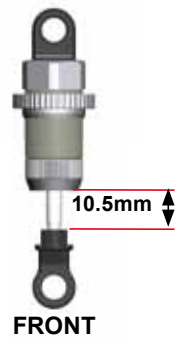

10.5mm

17.5mm

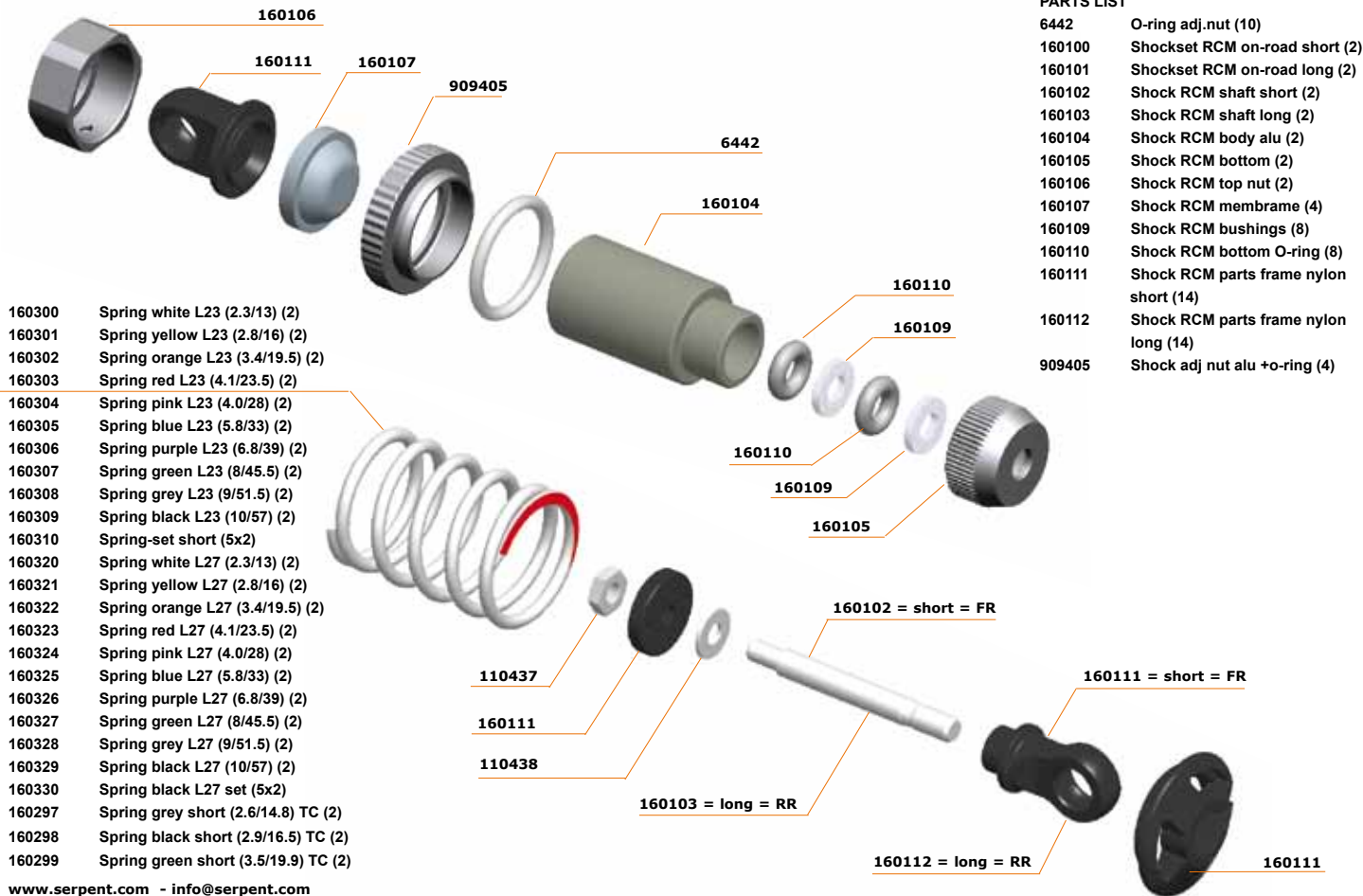

- 160300 Spring white L23 (2.3/13) (2)
- 160301 Spring yellow L23 (2.8/16) (2)
- 160302 Spring orange L23 (3.4/19.5) (2)
- 160303 Spring red L23 (4.1/23.5) (2)
- 160304 Spring pink L23 (4.0/28) (2)
- 160305 Spring blue L23 (5.8/33) (2)
- 160306 Spring purple L23 (6.8/39) (2)
- 160307 Spring green L23 (8/45.5) (2)
- 160308 Spring grey L23 (9/51.5) (2)
- 160309 Spring black L23 (10/57) (2)
- 160310 Spring-set short (5x2)
- 160320 Spring white L27 (2.3/13) (2)
- 160321 Spring yellow L27 (2.8/16) (2)
- 160322 Spring orange L27 (3.4/19.5) (2)
- 160323 Spring red L27 (4.1/23.5) (2)
- 160324 Spring pink L27 (4.0/28) (2)
- 160325 Spring blue L27 (5.8/33) (2)
- 160326 Spring purple L27 (6.8/39) (2)
- 160327 Spring green L27 (8/45.5) (2)
- 160328 Spring grey L27 (9/51.5) (2)
- 160329 Spring black L27 (10/57) (2)
- 160330 Spring black L27 set (5x2)
- 160297 Spring grey short (2.6/14.8) TC (2)
- 160298 Spring black short (2.9/16.5) TC (2)
- 160299 Spring green short (3.5/19.9) TC (2)

PARTS LIST

- 6442 O-ring adj.nut (10)
- 160100 Shockset RCM on-road short (2)
- 160101 Shockset RCM on-road long (2)
- 160102 Shock RCM shaft short (2)
- 160103 Shock RCM shaft long (2)
- 160104 Shock RCM body alu (2)
- 160105 Shock RCM bottom (2)
- 160106 Shock RCM top nut (2)
- 160107 Shock RCM membrame (4)
- 160109 Shock RCM bushings (8)
- 160110 Shock RCM bottom O-ring (8)
- 160111 Shock RCM parts frame nylon short (14)
- 160112 Shock RCM parts frame nylon long (14)
- 909405 Shock adj nut alu +o-ring (4)